

Your Town...Your Future

Rolleston Town Centre

Foster Recreation Park

Public Consultation on Draft Masterplans | September 2013



Public Drop-in Events www.selwyn.govt.nz/haveyoursay

Thursday 26 September
4-8pm at Council Headquarters, Rolleston

Wednesday 16 October
5-8pm at Council Headquarters, Rolleston

Sunday 20 October
1.30-4.30pm at Rolleston Community Centre

Rolleston's Future

We're consulting on draft Masterplans that have been prepared for the Town Centre and the Foster Recreation Park. These will guide Rolleston's development over the next 15 – 20 years.

We want you to be part of designing how Rolleston will look in the future. Have a read of this summary, come along to one of our drop-in sessions and then complete a feedback form to let us know what you think.

Rolleston is poised to become one of the most important growth areas in Canterbury. The town's population of around 9,000 is expected to increase to between 18,000 – 22,000 within 20 years.

Rolleston is the largest town in Selwyn District. Both Selwyn District and Rolleston are booming. Employment growth in Selwyn District was the strongest in New Zealand in 2012 at 9.5%. 1,200 new jobs were created in Selwyn last year.

Rolleston is also important as a service town for other areas of Selwyn District. Rolleston's success will be important to the rest of Selwyn's economy and our ability to continue to be seen as a desirable place to live.

Currently \$3 out of every \$4 earned in Selwyn is spent in Christchurch. There is the potential for Rolleston Town Centre to be home to new businesses offering a wide variety of products and services and to create new jobs. Rolleston will be one of

our main employment centres and people living in other parts of Selwyn will benefit from this by having the opportunity to work and shop in Rolleston as an alternative to having to commute to Christchurch. With a bigger population we can also support new community facilities and develop new public spaces and parks for people to enjoy. Rolleston's growth is therefore important to everyone living in Selwyn.

Foster Recreation Park will be the largest sport and recreation park in Selwyn and we have an exciting opportunity to develop it as a district hub for organised sport, walking and cycling, community events, relaxing in and for children to play in.

Rolleston has a lot of potential. The town is growing quickly but there are a number of issues and challenges:

- Rolleston doesn't have a main street or a town centre. This means that people tend to drive from one location to another. With no town centre it's also harder to create central public spaces which people will use.
- Rolleston Primary School, I-zone and the Council offices are key areas but are not well connected to the shopping area.
- The new Aquatic Centre, Foster Recreation Park, Clearview Primary and the new high school to the south of the town centre will become increasingly busy locations and there is the opportunity to create a well connected recreation and education hub.
- Existing community facilities (Rolleston Library and the Rolleston Community Centre) and sports grounds are at capacity.



Community Input

In late 2012 we held a series of drop-in sessions for people to come along to and tell us how they would like the town centre to develop in the future. We also surveyed people about what they wanted to see provided at Foster Recreation Park.

Thinking about the future, some of the things people said they wanted to see included the following:

Town Centre

- Entertainment, cultural, community and library facilities
- Town square with indoor/outdoor dining, bars and the opportunity for a market
- Green space, sporting facilities, water features and public art
- Small shops and pedestrian-friendly streets
- Better connected streets and improved pedestrian and cycle safety, including cycle links with I-Zone
- Improved access to SH1 that does not cause major delays
- Free parking
- Development that is a showcase for Selwyn – a destination comprising modern 'green' architecture

Foster Recreation Park

- Green space and trees for shelter and shade, seating and space to relax
- Pathways and tracks for walking, running and cycling
- Playgrounds and space for sports games (both organised and informal games)
- Lots more space for sports clubs to grow
- To share facilities with the high school
- To use the park to host community events
- To see groups and organisations work together to develop and use the park

Based on your feedback we have prepared two draft masterplans: one for the Town Centre and the other for the Foster Recreation Park. The following pages summarise the key features of each Masterplan.



Have your say...

Want to find out more information...

View copies of the Masterplan documents online at:
www.selwyn.govt.nz/haveyoursay

Drop-in events...come along to one of the events:

- **Thursday 26 September - 4-8pm** at Council Headquarters, Rolleston
- **Wednesday 16 October - 5-8pm** at Council Headquarters, Rolleston
- **Sunday 20 October - 1.30-4.30pm** at Rolleston Community Centre

Want to share your views on these projects...

Fill out the **Feedback Form** attached or online at:
www.selwyn.govt.nz/haveyoursay

The feedback period closes on **25 October 2013**.

Town Centre Contact:

Cameron Wood
Selwyn District Council
cameron.wood@selwyn.govt.nz
(03) 347 2811

Foster Recreation Park Contact:

Mark Rykers
Selwyn District Council
mark.rykers@selwyn.govt.nz
(03) 347 2812

Project timeline

October
Consultation on Masterplans closes
(25 October)

November/ December
Council staff review feedback
Public has opportunity to present their comments to Council

January 2014
Finalise Masterplans

February/ March
Adoption of Masterplans by Council



The Town Centre

The draft Town Centre Masterplan presents a future vision for the centre.

By 2031 Rolleston Town Centre will be a thriving destination at the heart of Rolleston where people will come to work, shop and play. The centre will be:

- Locally distinctive;
- Family and child-friendly;
- Developed with quality buildings and streets;
- Sustainable;
- A place incorporating green and urban public spaces; and
- Economically competitive

Based on this vision the draft Masterplan introduces a number of 'key projects' and these are outlined on the following pages.

It is a long term vision and will be implemented in stages by both the public and private sectors working together. The implementation of the Masterplan will bring the Town Centre to life and enable the creation of a destination to be proud of.



Town Centre Masterplan

Key Projects

A key aspect of the Masterplan is the focus on several main projects. These projects would unlock the potential of the Town Centre.

In addition, there are a number of privately owned development sites, e.g. the land next to Countdown which provides significant opportunities and would over time make a contribution to delivering change in the Town Centre.

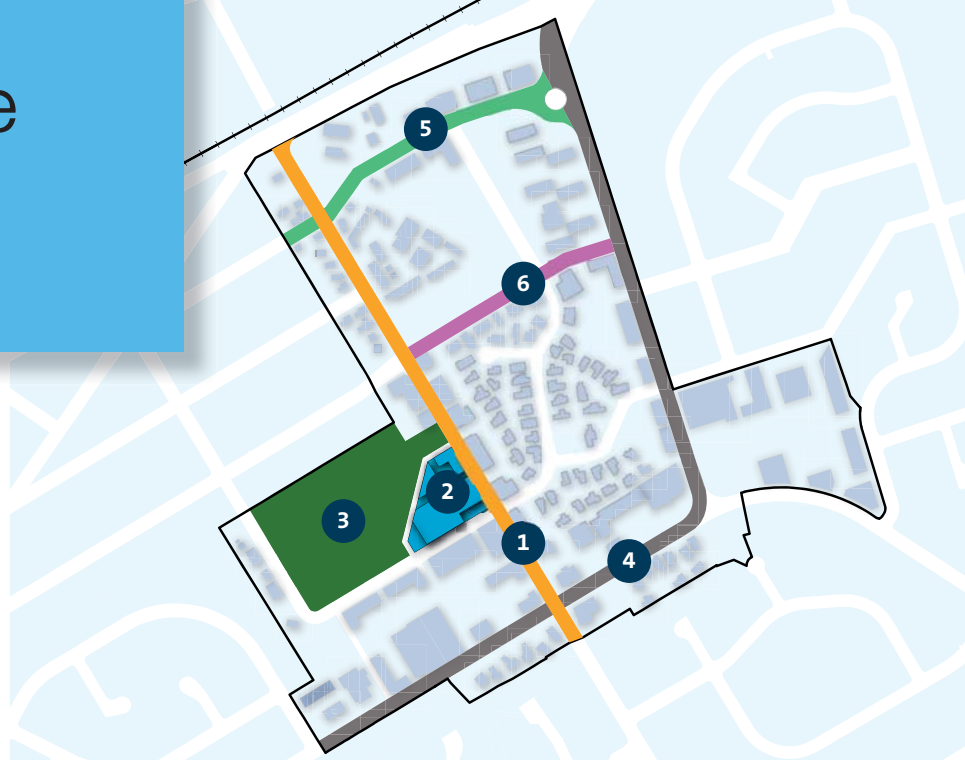

1

Tennyson Street becomes Rolleston's 'High Street'

Tennyson Street would be developed as a two-sided shopping street and would become Rolleston's main street. It would be home to a range of shops and would have benches and attractive tree planting. The street would be designed to be pedestrian-friendly with footpaths on both sides of the street, slow speed limits and space for on-street parking. Tennyson Street will also become a key route linking the new 'High Street' and the Foster Recreation Park. The existing water race may be piped to enable footpath improvements alongside the primary school.



3

Enhance Rolleston Reserve

Enhancements are planned to Rolleston Reserve. A playground and water feature is planned close to a new library, community and technology centre. The existing ball courts, play centre and scout hall would stay on the Reserve and other sports would move once space and facilities were available at Foster Recreation Park. Open grassed areas would remain and landscaping would be introduced. The location of a new shopping area and the new library, community and technology centre would bring more people to this area and encourage people to visit the Reserve.



A new library/community/technology centre and town square



A new **Town Square** is proposed to be developed between the library and community centre and Tennyson Street's new shopping area. The compact square along with the Reserve would be a meeting place for locals and visitors, and a place for holding events and staging performances.

A new **library, community and technology centre** is proposed. The Rolleston library and community centre building is beyond capacity and will soon be too small to service the town. There is the opportunity to create a new library/community facility providing multi-use spaces. These could be used for performances, events, exhibitions, meetings, a business hub, and a wide range of other activities, like a cafe, cinema or auditorium, all underpinned by state of the art technology. Developing a new landmark library, community and technology centre would encourage people to visit this area, and bring energy and life to Tennyson Street as the new 'high' street.



Rolleston Drive

Rolleston Drive would continue to act as an important connection point between the State Highway and the town. Landscaping would be carried out to make the street more attractive. Pedestrian crossings /traffic lights would be installed to make it safer to cross this road and on-street parking may also be introduced.



5

Kidman Street Area

The Kidman Street area is focused around the expanded Rolleston School, the Selwyn District Council offices, and State Highway 1 and would be developed as a commercial office space. A Park & Ride facility is planned next to the Council Offices so that residents can more easily access and use public transport.

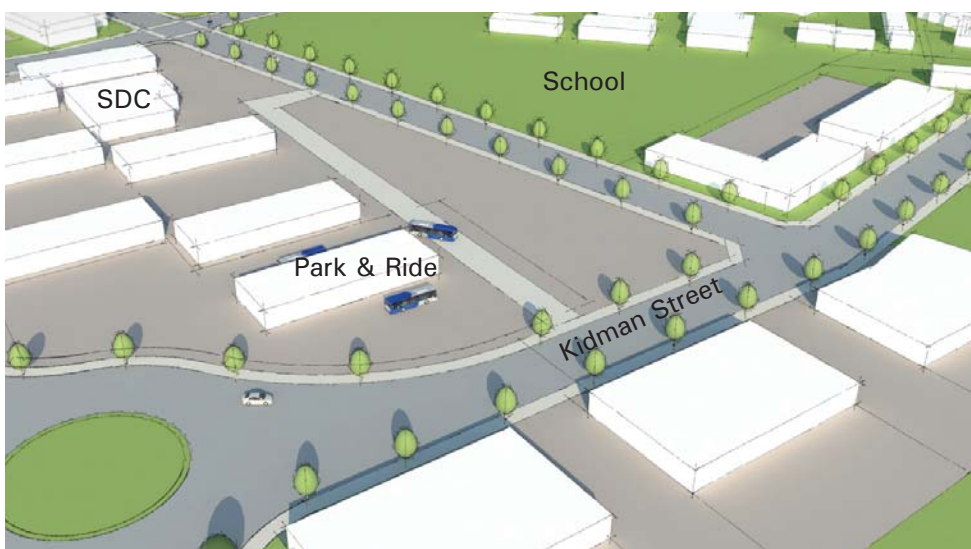

6

Moore Street Extension

A new road is proposed along the southern boundary of the larger school site in order to extend Moore Street. This enables the creation of a further east/west connection through the town centre.



Staged Development

The projects set out in the Town Centre Masterplan will be staged over two decades. Each of these projects will need to be costed and the Council will consult on how much our community wants to spend on these. The projects will happen in the following stages:

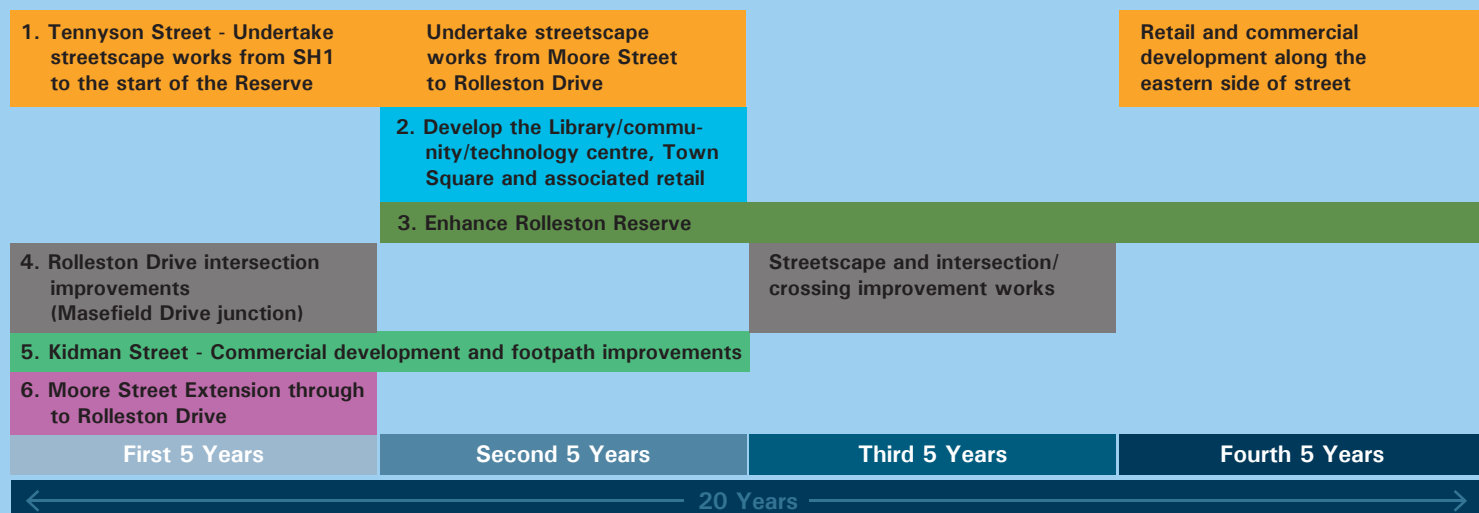

Foster Recreation Park

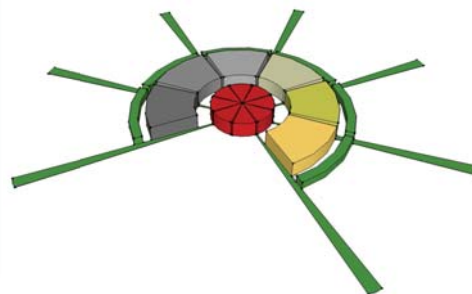

Foster Recreation Park (FRP) will be the largest sport and recreation park in Selwyn. The park is designed to be used for a range of activities – for sports training and games, for community events and concerts, for exercising dogs and for walking and cycling. A wide variety of outdoor and indoor sports and activities will be provided for, with flexibility to include new sports and activities as demand changes and develops. FRP will also have a large children's play area which will become the premier playground in Selwyn.

The FRP design plan is based around Three Hub areas –

1

A Facility Sports Hub:

A Facility Sports Hub area (indoor sports centre, including a fitness centre and indoor courts) in the North of the park based around the Aquatic Centre and a future indoor sports centre and planned future High School

2

An Outdoor Sports Hub:

An Outdoor Sports Hub area in the centre of the park with fields, courts and a major shared clubroom that can accommodate a range of outdoor sports (and potentially indoor sports)

3

A Recreation and Events Oval Hub:

A Recreation and Events Oval Hub – this area can be used for both community events like concerts and fields for sports activities



In total over 20 playing fields can be provided at FRP. An extensive network of walkways and cycleways join the three hubs together and provides safer off-road walking and cycling routes. Trees, plantings and seats will be included in the park to create an attractive environment for people to enjoy. Spaces have been designed to be multi-purpose and we want to encourage sports groups to share spaces and facilities so that the community receives the best value for money from its investment.

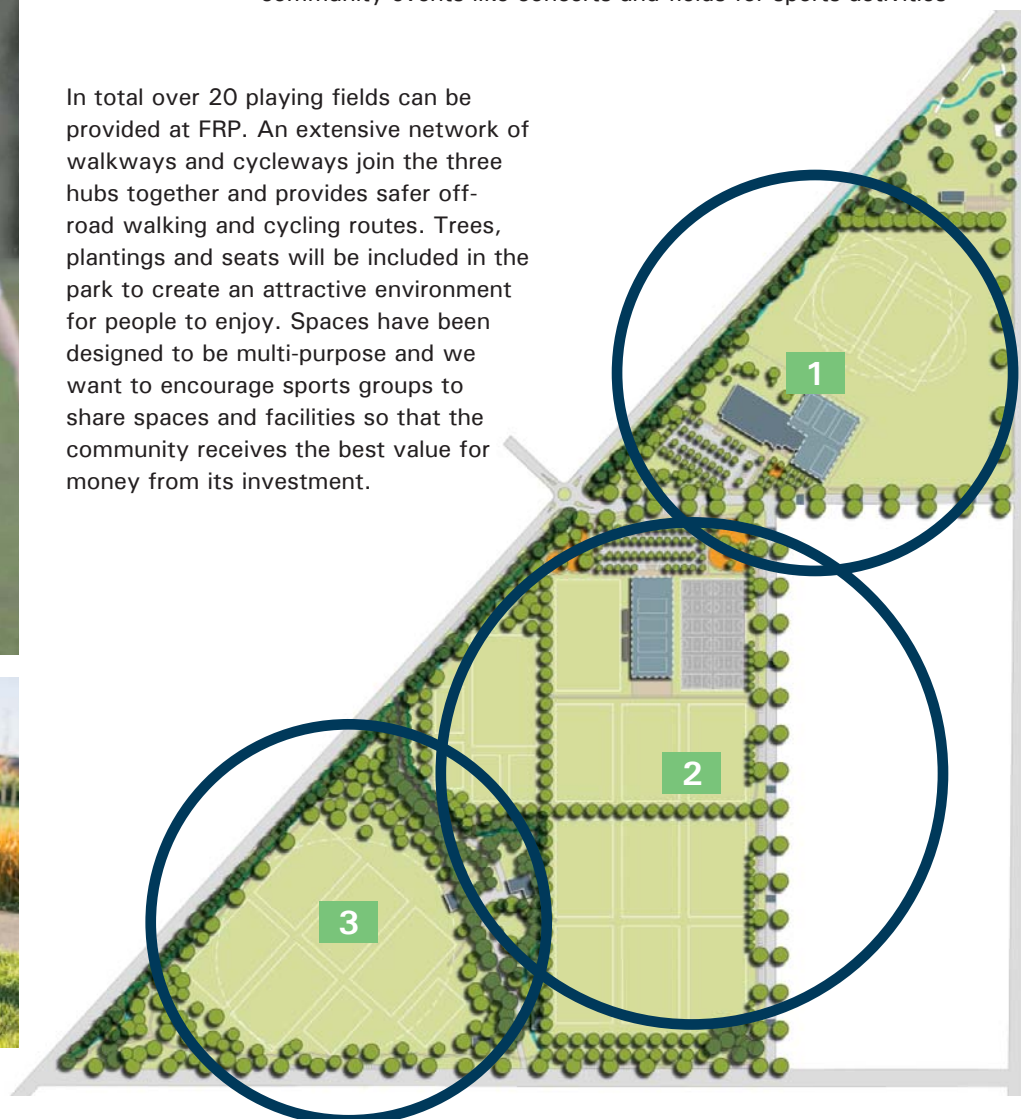

Foster Recreation Park Masterplan



- 1 Aquatic Centre
- 2 Arrival Sign, Artworks, Outdoor Fitness
- 3 Car Park
- 4 Car Park
- 5 Dog Park
- 6 Facility Sports Hub, Indoor Sports Courts
- 7 Foster Homestead, Dell and Play Equipment
- 8 High School Site
- 9 Kids and Youth Play Zones
- 10 Outdoor Sports Hub, Indoor Sports Courts
- 11 Recreation/Events Oval Hub
- 12 Sports Fields
- 13 Specimen Trees around Park and Avenues of Trees along Paths and Roadways
- 14 Wilderness Play amongst Specimen Tree Planting
- 15 Wilderness Play at former Quarry Pit
- 16 Potential cul-de-sac changes to Goulds Road

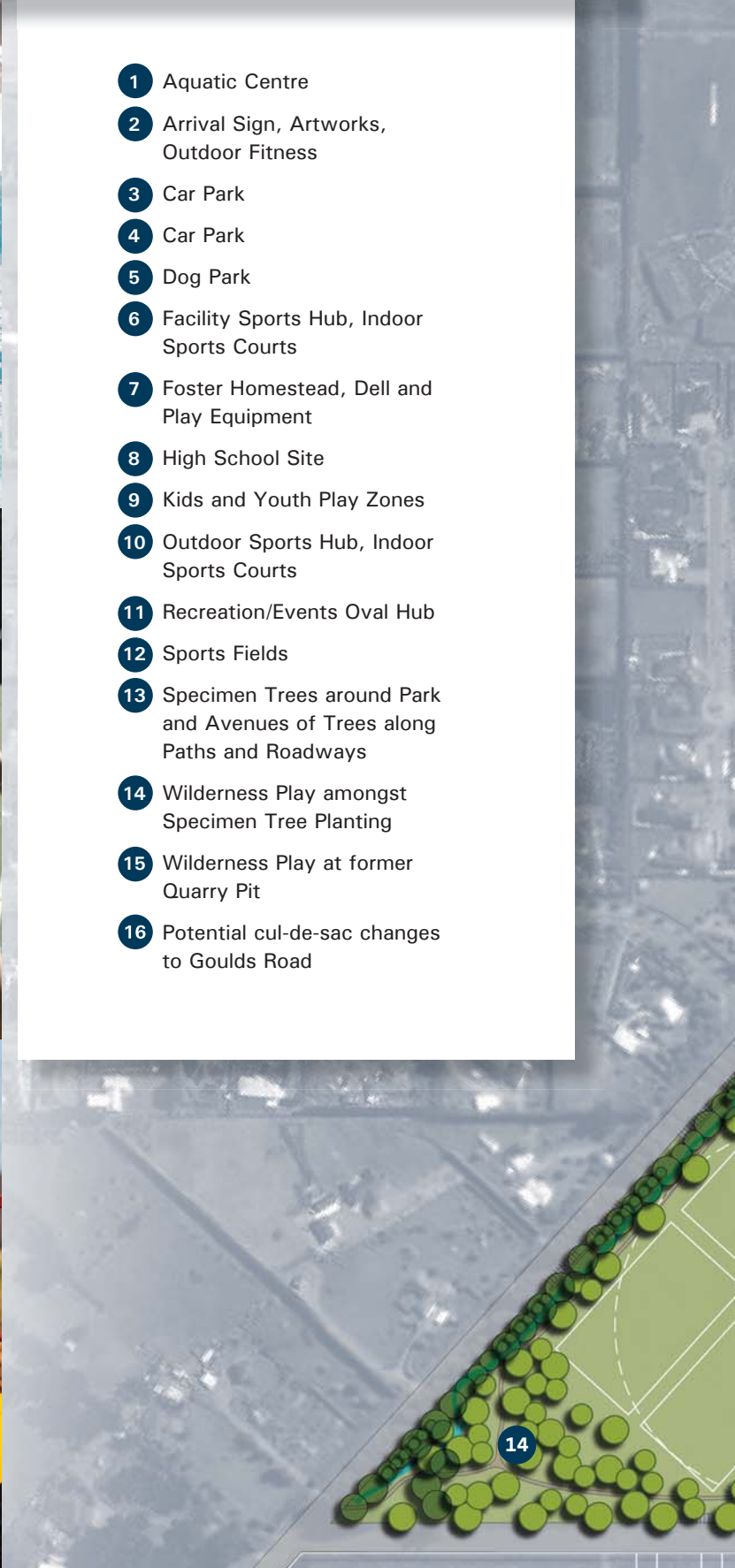



Clearview School

Broadlands Drive

Goulds Road

Broadlands Drive

Proposed New Park Lane

Springston - Rolleston Road

To Rolleston Town Centre

Faringdon Subdivision

Dynes Road

Implementation Staging Foster Recreation Park



There is an immediate need to start development of additional sports space at FRP along with other facilities and to continue to develop the park to keep pace with population growth. To achieve this a three stage approach is planned.

STAGE

1

Key projects in the next 5 years include:

- Development of around 8 hectares of sports fields (Approximately 7 fields)
- Construction of the first part of the sports hub building with changing rooms and toilets, and possibly basic clubrooms (at FRP and Brookside Park)
- Childrens and youth play facilities
- Car parks, paths and landscape works to service this area
- Ministry of Education planned development of High School

STAGE

2

Some key projects planned in 5-10 years include:

- Development of the first stage of an indoor sports facility including 2 courts and a fitness centre
- An outdoor events hub
- Up to 8 hectares of sports fields (Approximately 7 fields)
- Development of landscaped grounds and activities adjacent to the homestead

STAGE

3

Projects planned in 10-20 years include:

- Development of around 7 hectares of sports fields (Approximately 6 fields)
- Extension of the indoor sports facility with additional courts
- Extension of the outdoor sports hub building
- Possible closing of a section of Goulds Road
- Large netball hub (12 outdoor courts)

For more information on implications for sports refer to the full Foster Recreation Park Masterplan available on the Council's website.

