

Appendix C

Proposed Kirwee Reserve Master Plan



KEY

- Floodlights
- Large Specimen Trees
- Small Specimen Trees
- Shrub Border

GENERAL DESIGN INTENT:

The Kirwee Reserve Master Plan has been developed to ensure the new reserve extension is developed in a cohesive manner, inkeeping with existing reserve qualities, while providing opportunity to enhance and provide for new activities. The Reserve Master Plan seeks to increase utilisation and ensure the reserve continues to serve the Kirwee Community as a central hub, providing recreational opportunities for all.

The main design decisions include:

- 1 Realignment of the No2 rugby field to fit a second junior field.
- 2 Creation of a second dedicated grass cricket wicket to cater to growth of this sport in the Malvern area.
- 3 Provision of a general open space that is available for offleash dog exercise.
- 4 Provision of a formed perimeter footpath/walkway, improving access around the reserve and providing opportunity for the likes of a fitness trail/stations.
- 5 Natural play area including BMX/Pump Track.
- 6 Creation of a community activity hub, including reserve amenities such as seating, picnicking, BBQ, community events, senior and junior play equipment, BBAll half court and public toilets.
- 7 Extensive mixed native and exotic plantings to provide shelter and shade, and improve reserve amenity values.
- 8 Removal of existing pine hedge to allow realignment of sports fields and the efficient utilisation of available reserve space, but with provision for an increase in taller shelter planting overall.

NOTES

DRAFT FOR NOTIFICATION

REV	DATE	DESCRIPTION
A	01.04.19	DRAFT FOR DISCUSSION
B	31.05.19	DRAFT FOR DISCUSSION
C	26.06.19	DRAFT FOR NOTIFICATION

KIRWEE RECREATION RESERVE

Concept Plan Set
SHEET 001 CONCEPTUAL SITE LAYOUT

Design Drawn Check Appv'd	Scale 1:1200 @ A2	Date 26.06.19
DRAWING NO. 000_000	REVISION (C)	

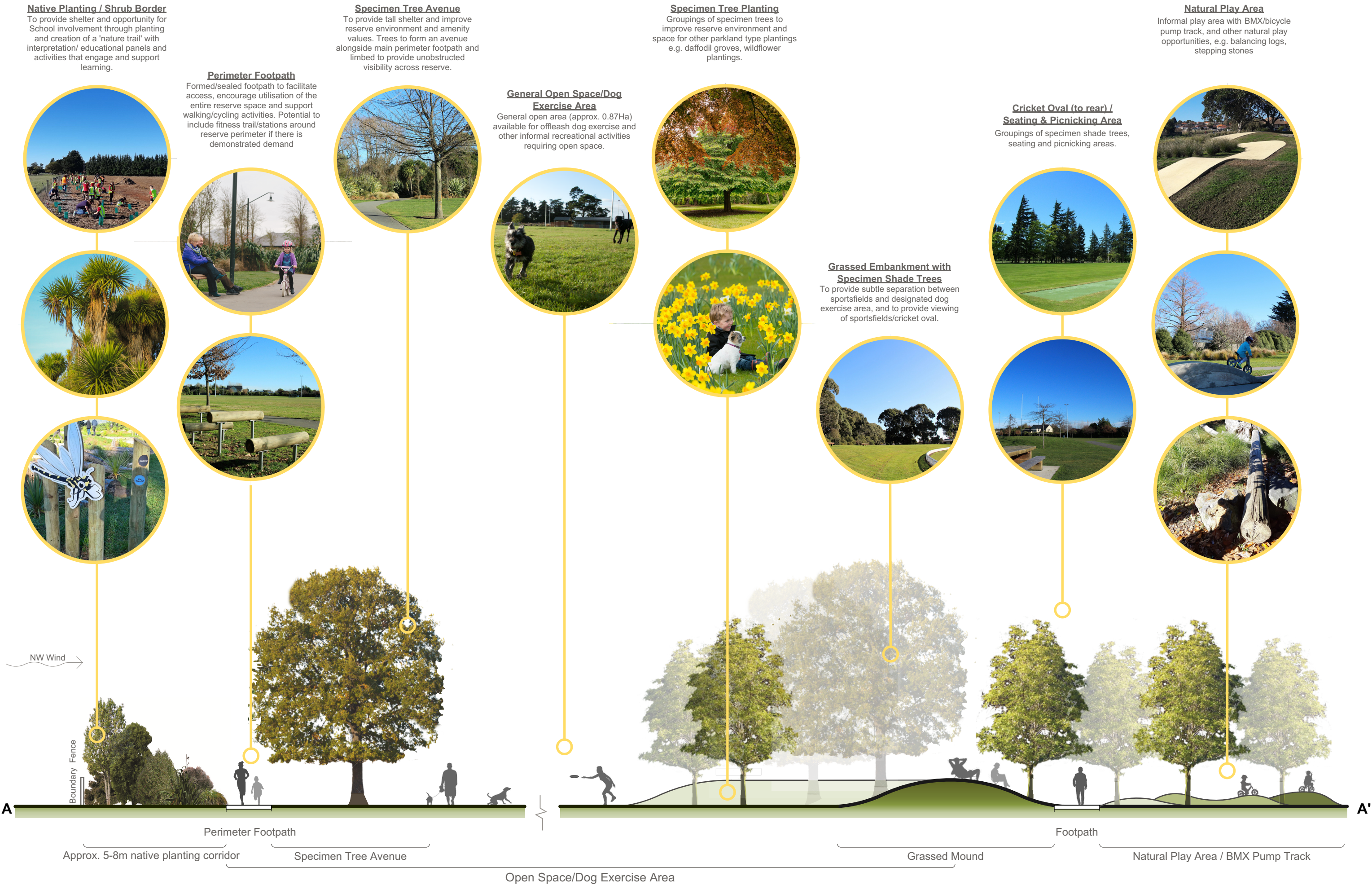

Typical Cross Section B-B' - Central Tree Avenue & Footpath
Scale 1:50 @ A3

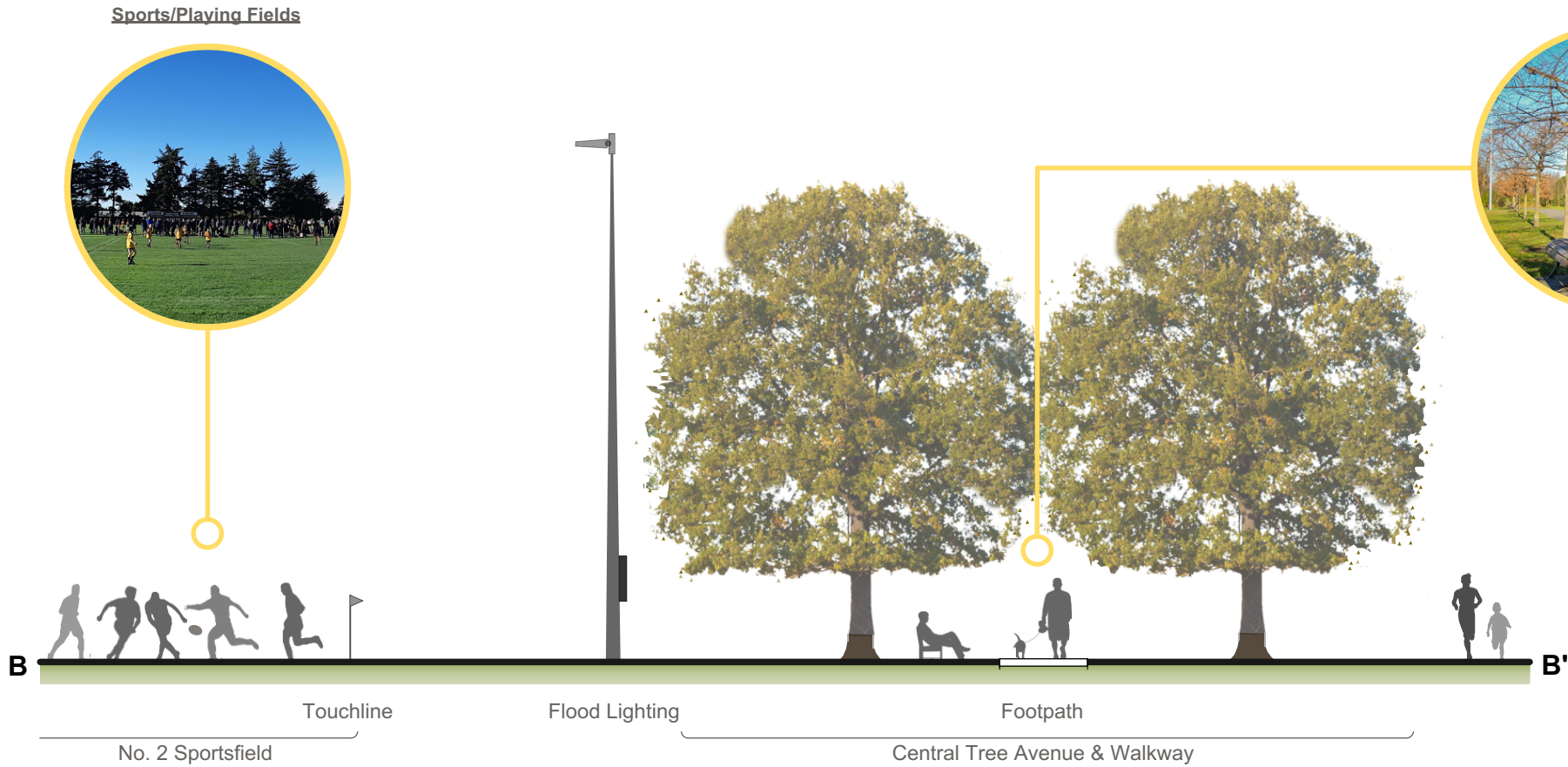

Central Tree Avenue & Walkway

Avenue of larger deciduous specimen trees, limbed to allow visibility across reserve, lining either side of a formed pathway that links to melenium walkway/Hoskyns Rd

BBall Half Court

Informal play area Basket ball half court with very basic scooter/skate facilities around court perimeter



Public Shelters

Public shelters (x2) with seating and option of BBQ's, with surrounding picnic facilities (e.g. grass mounds, picnic tables, drinking fountain, rubbish bins and shade trees)



Typical Cross Section C-C' - Community Recreation Hub
Scale 1:150 @ A3

Community Event Space

Space for organised outdoor events and community gatherings



Footpath Network

Sealed footpaths providing access and play (scooter/bike/skate)



Senior Play Space

Play equipment for children aged (6+), e.g. flying fox, swings, high climbing structures, scooter track



Junior Play Space

Play equipment for children aged (5 and under), e.g. swings, modular play, spinners, natural play



Junior Play Space

Play equipment for children aged (5 and under), e.g. swings, modular play, spinners, natural play



Junior Play Space

Play equipment for children aged (5 and under), e.g. swings, modular play, spinners, natural play

