

Lincoln ODP Amendments Required

All changes need to be shown with the new changes highlighted in some way so that they can be easily referenced.

ODP Area 1

- Delete the notation 'potential stormwater management area' over the land identified below which is contained within ODP Area 1 - (Recommendation No 2)

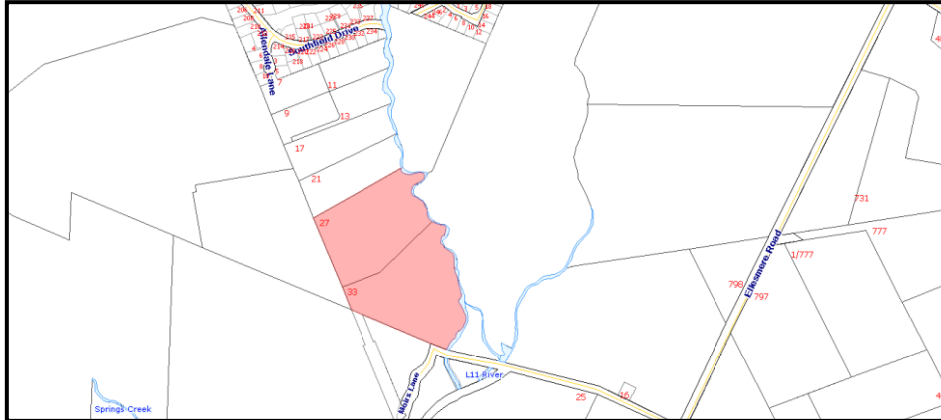

ODP Area 2

- Identify the 'Spring Waterway' to be included on the Stormwater and Sewer Network Plan- (Recommendation No 38) – Exact location to be provided by Hugh Blake-Manson.

ODP Area 3

- Add a note to the Browns Lane cycleway/walkway to show that this aspect of the ODP is “deferred until Duncan’s block developed for residential” - (Recommendation No 40).
- Remove the identified School Site from the ODP but place a Note on the ODP that a school site is to be recognised following agreement with MfEd” - (Recommendation No 44).

ODP Area 4

- Insert reference to a 20m Landscape Buffer to be provided from Smiths Block (southwestern corner of ODP) – (Recommendation 47).
- Remove excess roading arrow from ODP. The arrow to be removed is that which is actually located outside the ODP boundary and within the ‘Smith Block’ - (Recommendation 48).

ODP Area 5

- Remove old Railway line from ODP Area 5 (Recommendation 52)

ODP Area 6

- Identify a building setback of 5m and a two storey setback of 12m from the eastern ODP boundary (adjacent to Roblyn Place residents) – Recommendation 54.
- Identify 20m esplanade reserve adjacent to the Liffey Stream – Recommendation 55.

Rolleston ODP Amendments

ODP Area 1

- Remove text “PT Res 1759” from ODP 1 and show this land as included within the ODP area - (Recommendation 16).
- Remove Comprehensive Development Area from ODP Area 1 - (Recommendation 18).
- Insert note along the lines of the following: “ODP Area 1 may be a suitable location for a primary school, further discussions will need to occur between the Ministry of Education and the Landowner in this area before confirming this” - (Recommendation 19).
- Change “Walker Road” to “Dunns Crossing Road”.

ODP Area 2

- Introduce ODP Area 2 which was introduced via a submission as per recommendation 22.

ODP Area 6

- Introduce ODP Area 6 which was introduced via a submission as per recommendation 30. Note: that the areas shown for neighbourhood and local centres must be reduced to show compliance with the 2000m² limit.

Planning Maps

- Change Proposed Planning Maps 14A-C and 115 to reduce the land area covered by ODP Area 5 overlay so that it does not include any University land. At present the northern boundary of ODP area incorrectly includes a strip of land (old railway land) within University land (Recommendation 52)
- Rezone “Living Z deferred” land to “Living Z” on planning maps 97 and 98 in accordance with the area covered by Rolleston ODP Area 2 (Recommendation 22).

- Rezone “Living Z deferred” land to “Living Z” on planning maps 106, 107, 108 and 108A in accordance with the area covered by Rolleston ODP Area 6 (Recommendation 30).