



Appendix 1

Proposed Outline Development Plan



Appendix 2

IPort Road Network



Application for
Subdivision Consent

Comprised in CFR CB31A/670,
882713, 882714, 882715, 181742

Total Area : 48.3698 Ha

ZONE : BUSINESS 2A & INNER PLAINS
Selwyn District Plan
(Operative)

NOTE : Areas and dimensions are subject to final survey

THIS PLAN IS PREPARED FOR THE PURPOSE
OF OBTAINING A RESOURCE CONSENT
FROM COUNCIL TO THE DEVELOPMENT
THE INFORMATION CONTAINED HEREON SHOULD
NOT BE USED FOR OTHER PURPOSES

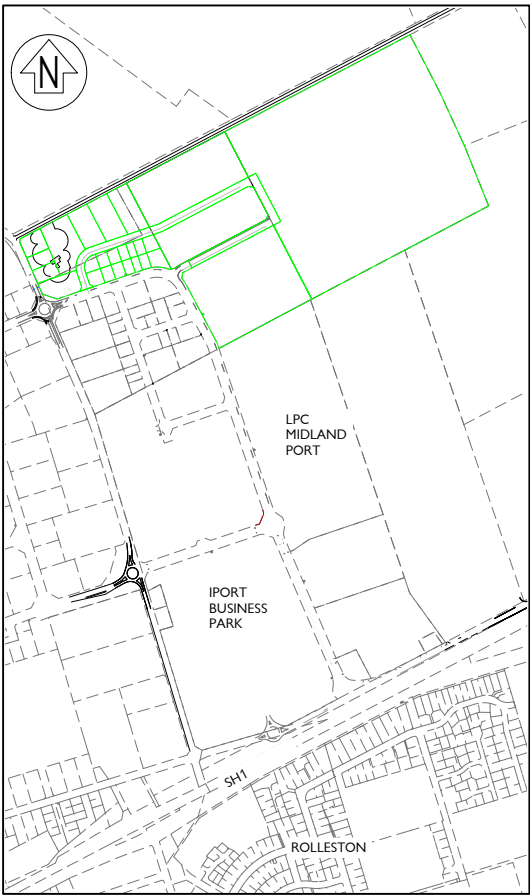

LOCATION DIAGRAM
SCALE 1:10000 [A1]

IPOINT BUSINESS PARK

LOT 2 DP 535292
IPOINT BUSINESS PARK

LPC MIDLAND PORT

No.	Amendment	Drawn	Date	Surveyed:	Survey Date:	Name	Date	Client
A	ISSUE FOR CLIENT REVIEW	JZ	23.10.19	-	-	Designed	-	-
B	ISSUE FOR CONSENT APPLICATION	JZ	25.10.2019	Coord System: NZGD2000 Mt Pleasant	-	Drawn	J.ZHOU 22.10.2019	-
				Calibration: -	-	Dr. Chk	T.McLEOD 22.10.2019	-
				Origin of Levels: BM B882	Datum: Lyttelton 1937	Proj. Mgr	T.McLEOD 09.08.2019	-
				SS Pin in Conc.	-	Design Review	-	-
				Jones Road	-	Approved	-	-
				R.L. 55.934m (LINZ DEC 2013)	-	T.McLEOD	23.10.2019	-



Project Title	Project No.	Set No.	Sht No.	Rev
IPOINT INDUSTRIAL DEVELOPMENT JONES ROAD, ROLLESTON	450029	C1	01	B
Drawing Title	Eliot Sinclair surveyors engineers planners			
SUBDIVISION PLAN FOR STAGE 11 OVERVIEW PLAN				
Scales	[A1] 1:1000 [A3] 1:2000			

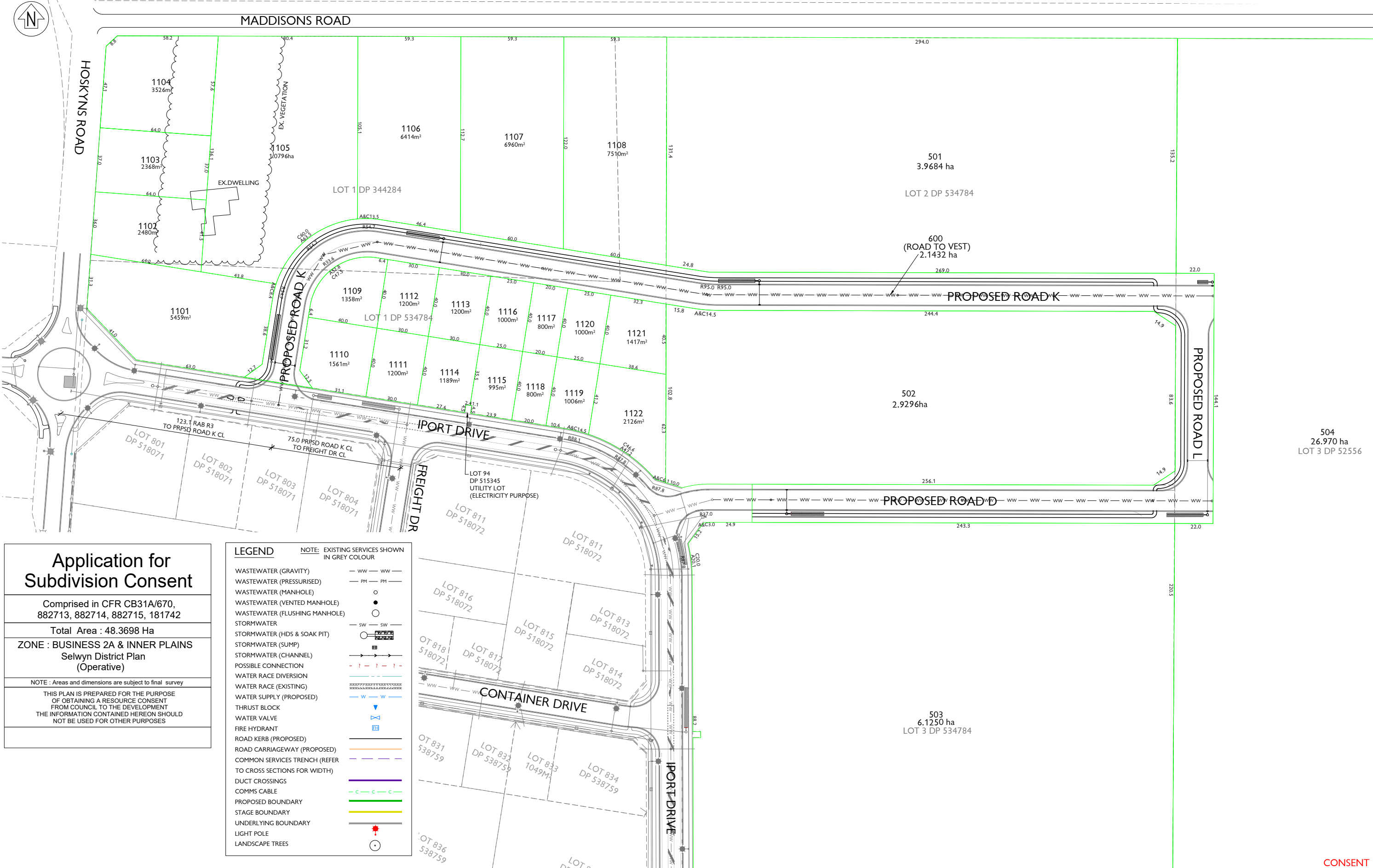

Application for Subdivision Consent

Comprised in CFR CB31A/670, 882713, 882714, 882715, 181742

Total Area : 48.3698 Ha

ZONE : BUSINESS 2A & INNER PLAINS Selwyn District Plan (Operative)

NOTE : Areas and dimensions are subject to final survey

THIS PLAN IS PREPARED FOR THE PURPOSE OF OBTAINING A RESOURCE CONSENT FROM COUNCIL TO THE DEVELOPMENT. THE INFORMATION CONTAINED HEREON SHOULD NOT BE USED FOR OTHER PURPOSES

LEGEND

NOTE: EXISTING SERVICES SHOWN IN GREY COLOUR

WASTEWATER (GRAVITY) — ww — ww —

WASTEWATER (PRESSURISED) — PM — PM —

WASTEWATER (MANHOLE) ○

WASTEWATER (VENTED MANHOLE) ○

WASTEWATER (FLUSHING MANHOLE) ○

STORMWATER — sw — sw —

STORMWATER (HDS & SOAK PIT) [Symbol]

STORMWATER (SUMP) [Symbol]

STORMWATER (CHANNEL) [Symbol]

POSSIBLE CONNECTION - - - - -

WATER RACE DIVERSION [Symbol]

WATER RACE (EXISTING) [Symbol]

WATER SUPPLY (PROPOSED) [Symbol]

THRUST BLOCK [Symbol]

WATER VALVE [Symbol]

FIRE HYDRANT [Symbol]

ROAD KERB (PROPOSED) [Symbol]

ROAD CARRIAGEWAY (PROPOSED) [Symbol]

COMMON SERVICES TRENCH (REFER TO CROSS SECTIONS FOR WIDTH) [Symbol]

DUCT CROSSINGS [Symbol]

COMMS CABLE [Symbol]

PROPOSED BOUNDARY [Symbol]

STAGE BOUNDARY [Symbol]

UNDERLYING BOUNDARY [Symbol]

LIGHT POLE [Symbol]

LANDSCAPE TREES [Symbol]

No.	Amendment	Drawn	Date	Surveyed:	Survey Date:	Name	Date	Client
A	ISSUE FOR CLIENT REVIEW	JZ	22.10.2019	Coord System: NZGD2000 Mt Pleasant	-	Designed: J.ZHOU	22.10.2019	
B	ISSUE FOR CONSENT APPLICATION	JZ	25.10.2019	Calibration: -	-	Drawn: T.McLEOD	22.10.2019	
				Origin of Levels: BM B882	Datum: Lyttelton 1937	Proj. Mgr: T.McLEOD	09.08.2019	
				SS Pin in Conc. Jones Road		Design Review: -	-	
				R.L. 55.934m (LINZ DEC 2013)		Approved: T.McLEOD	22.10.2019	



Project Title I PORT INDUSTRIAL DEVELOPMENT JONES ROAD, ROLLESTON	Project No. 450029	Set No. C1	Sht No. 02	Rev B
Drawing Title SUBDIVISION PLAN FOR STAGE 11 BEING SUBDIVISION OF LOT 1 DP 344284, LOTS 1-3 DP 534784, & LOT 3 DP 52556				
Scales [A1] 1:1000 [A3] 1:2000				

Eliot Sinclair
surveyors | engineers | planners

Application for Subdivision Consent

Comprised in CFR CB31A/670,
882713, 882714, 882715, 181742

Total Area : 48.3698 Ha

ZONE : BUSINESS 2A & INNER PLAINS
Selwyn District Plan
(Operative)

NOTE : Areas and dimensions are subject to final survey

THIS PLAN IS PREPARED FOR THE PURPOSE
OF OBTAINING A RESOURCE CONSENT
FROM COUNCIL TO THE DEVELOPMENT
THE INFORMATION CONTAINED HEREON SHOULD
NOT BE USED FOR OTHER PURPOSES

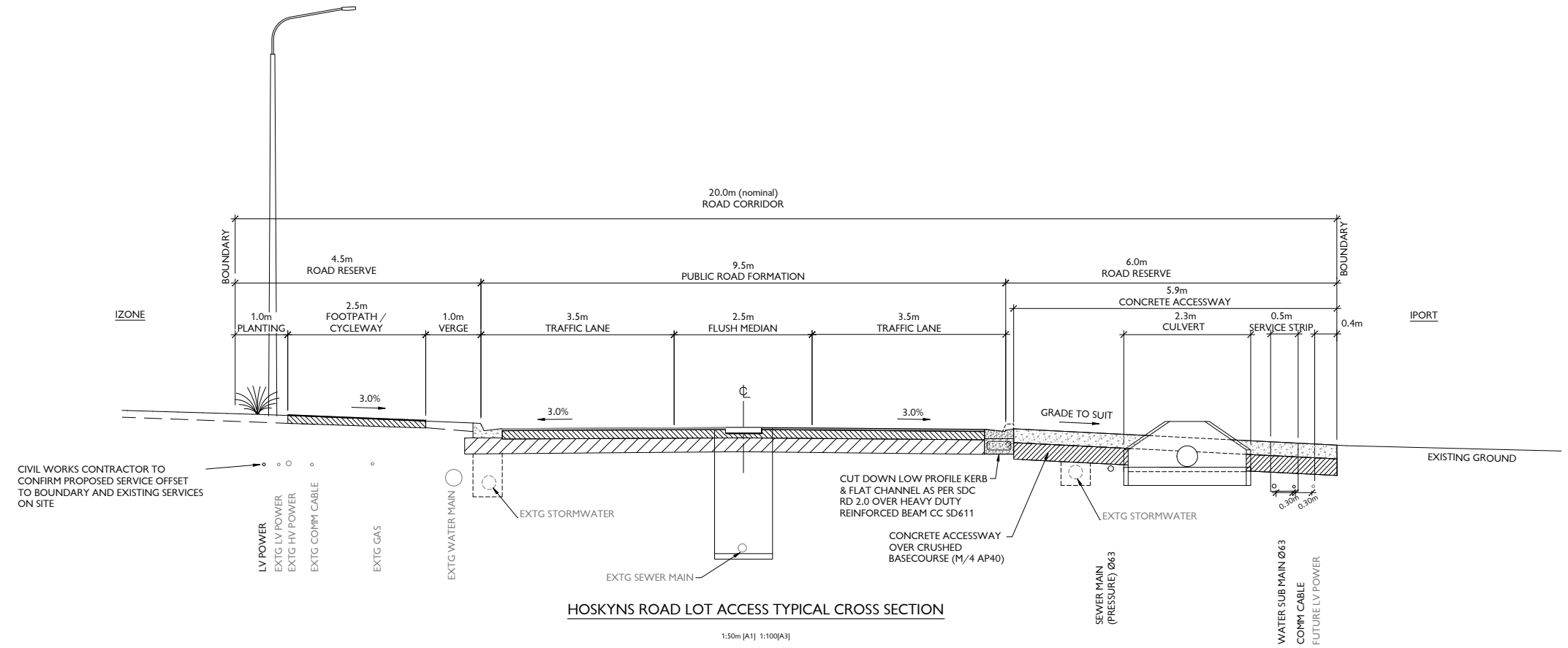
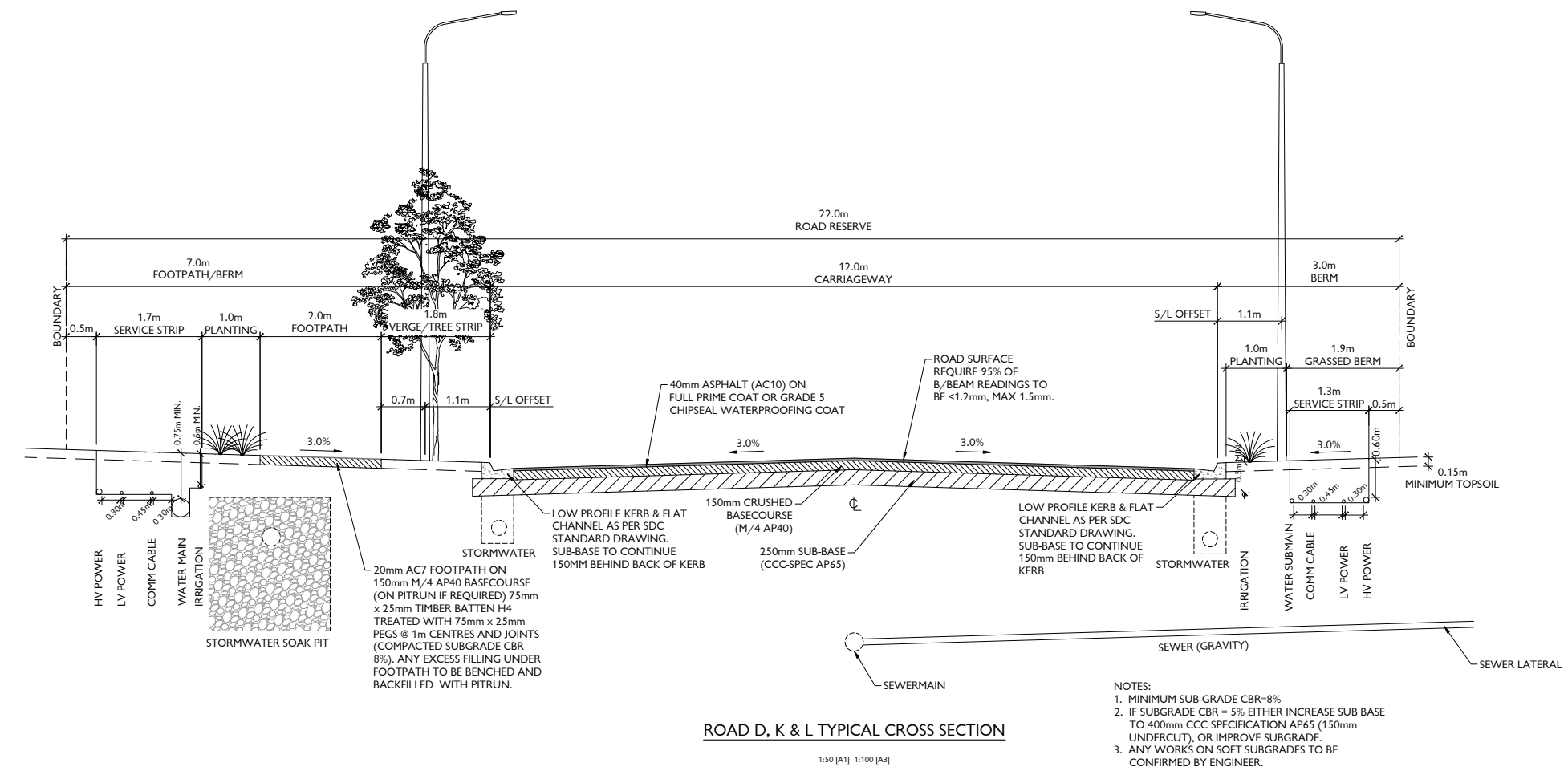

CONSENT

No.	Amendment	Drawn	Date	Surveyed:	Survey Date:	Name	Date	Client	Project Title	Project No.	Set No.	Sht No.	Rev
A	ISSUE FOR CLIENT REVIEW	JZ	24.10.2019	Coord System: NZGD2000 Mt Pleasant	-	Designed	-	-	IPOINT INDUSTRIAL DEVELOPMENT JONES ROAD, ROLLESTON	450029	C1	03	B
B	ISSUE FOR CONSENT APPLICATION	JZ	25.10.2019	Calibration: -	-	Drawn	J.ZHOU	22.10.2019					
				Origin of Levels: BM B882	Datum: Lyttelton 1937	Dr. Chk	T.McLEOD	22.10.2019	STAGE 11 SUBDIVISION PLAN TYPICAL ROAD CROSS SECTIONS				
				SS Pin in Conc. Jones Road		Proj. Mgr	T.McLEOD	09.08.2019					
				R.L. 55.934m (LINZ DEC 2013)		Design Review	-	-	Scales AS SHOWN				
						Approved	T.McLEOD	22.10.2019					



Eliot Sinclair
surveyors | engineers | planners