

LOCATION PLAN
1:3000

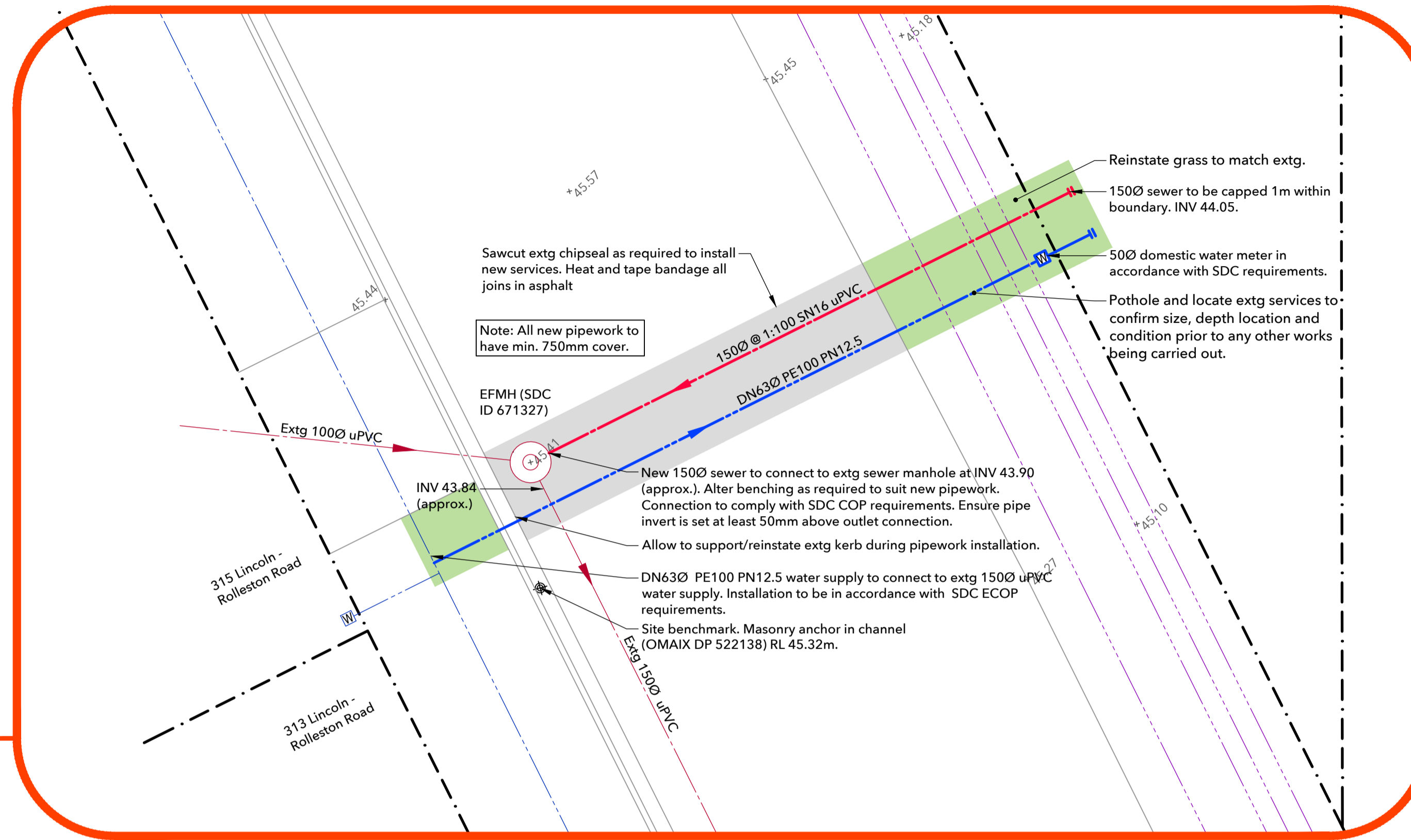

DRAINAGE PLAN
1:100

KEY	
	Approximate legal boundaries for information only
	Extg foul sewer
	New foul sewer
	Extg water
	New water
	Extg power
	Extg comms.
	Extg water meter
	New water meter

NOTES:

SDC COP - Refers to the Selwyn District Council's Code of practice.

It is a requirement that only SDC approved drainlayers are permitted to work within street or road boundaries.

All works are to comply with the relevant sections of the SDC COP.

Refer to the Civil specification for all testing requirements.

The Contractor is to confirm the invert levels of the relevant existing stormwater and sewer pipes prior to commencing work on site.

The sewer system has been designed to NZS/AS3500.

All joints against existing asphalt shall be bandaged and sealed on the completion of the works.

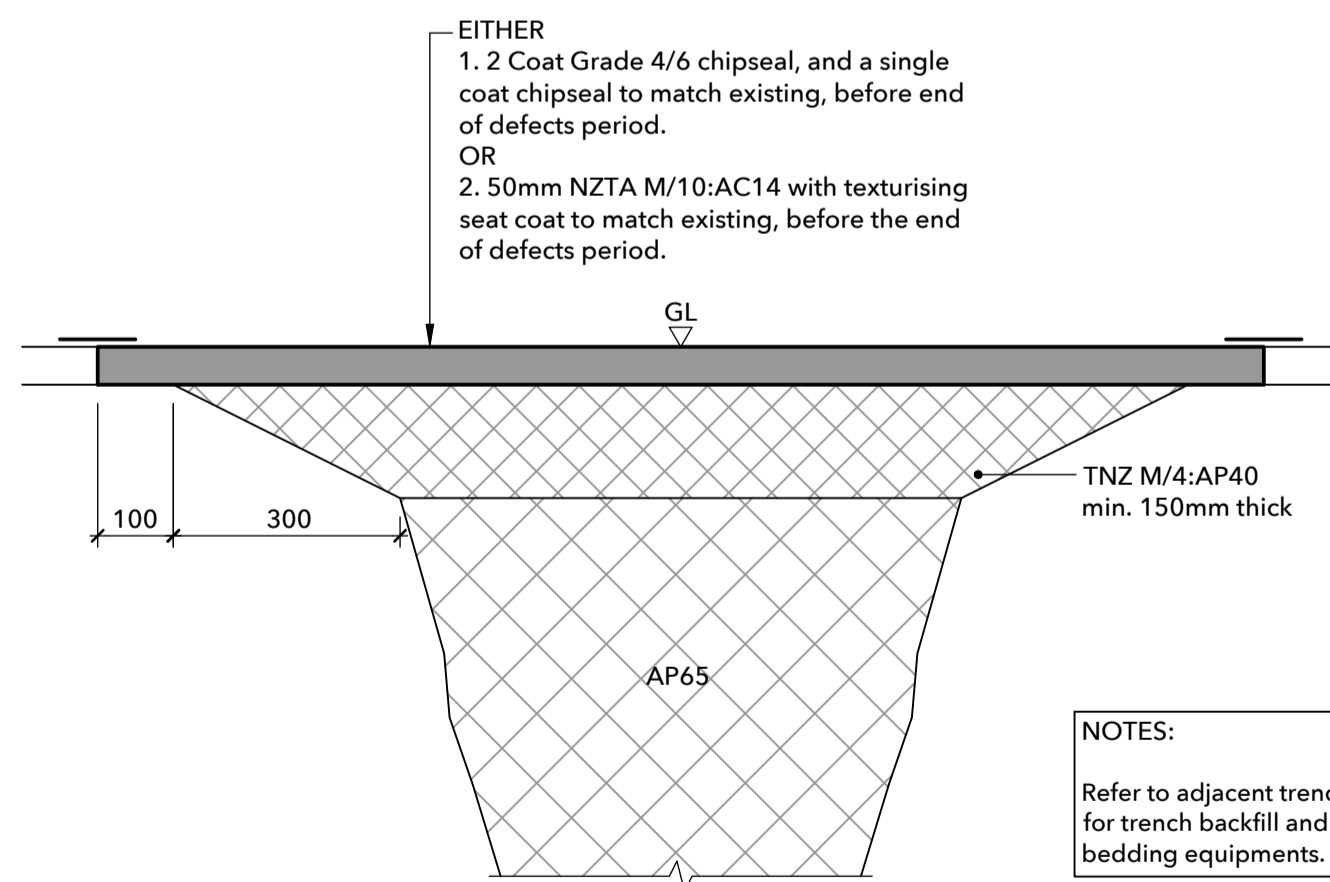

TRENCH REINSTATEMENT - CHIPSEAL
1:10

NOTES:
Refer to adjacent trench detail for trench backfill and pipe bedding equipments.

Zone	Material
Base course	AP40
Sub-base	AP65 thickness to match existing or specified sub - base thickness as detailed on pavement section.
Trench Fill	AP65
Bedding	AP20
Over-excavation	

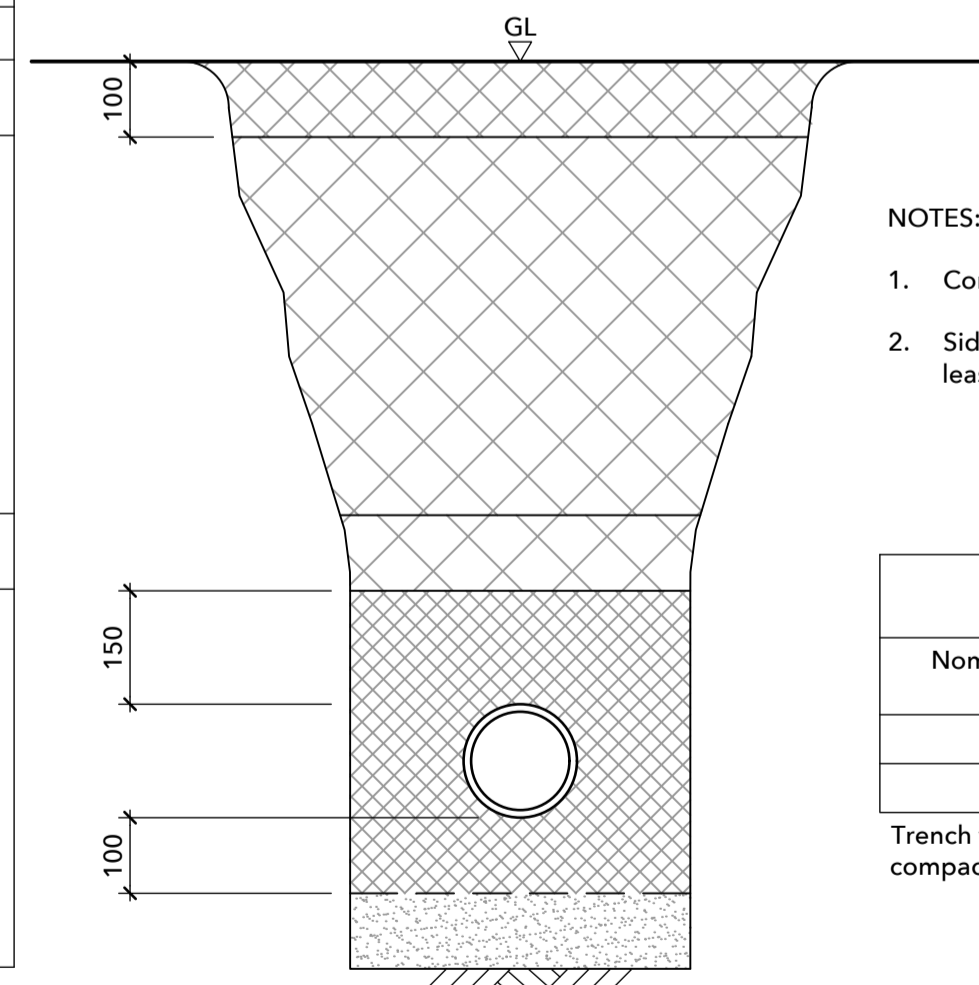

STANDARD TRENCH DETAIL - HARDSTAND AREAS
1:10

- NOTES:**
1. Compact and evenly grade finish trench floor.
 2. Sides of excavation to be kept vertical to at least 150 above the pipe.

TRENCH CLEARANCE	
Nominal Diameter	Minimum Clearance
100	100
150-300	150

Trench width to enable pipe to be safely laid and compacted around the side support zone.

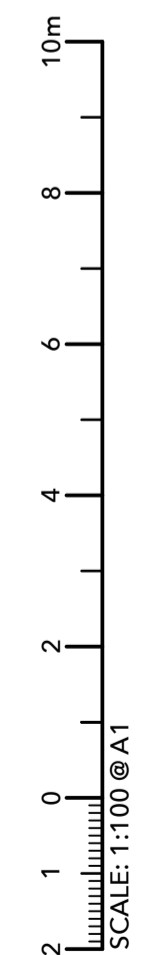

ORIGINAL DRAWING IN COLOUR

This drawing is copyright © Contractor must verify all dimensions on site
Powell Fenwick Consultants Limited trading as Powell Fenwick
03 366 1777 www.pfc.co.nz Christchurch Queenstown
7/12/2024 10:24:13 am

147 LEVI ROAD REZONING ROLLESTON

SERVICES PROVISIONS

2	12.07.24	For Information
1	05.07.24	For Information
ISSUE	DATE	AMENDMENT



CIVIL		SCALE AT A1		ISSUE	
DESIGNED	RT	AS SHOWN		2	
DRAWN	RT				
CHECKED					
REFERENCE		DISCIPLINE	ZONE	SHEET	LEVEL
240795 -	PF-CV	- 00	- 0101	- 00	