

Planning Unit

Application for Resource Consent

Resource Management Act 1991 - Form 9

Send or deliver your application to: Selwyn District Council, PO Box 90, Rolleston 7643

Or email to: rcapps@selwyn.govt.nz

For enquiries phone: (03) 347-2868

For enquiries email: planninginfo@selwyn.govt.nz

1. Application

This form is to be used for an application as required under Section 88 of the Resource Management Act 1991 and must be accompanied by the required fee, together with an assessment of environmental effects, plans and a Certificate of Title and any other supporting information. If this application is for a subdivision then a geotechnical report must be attached.

This application is for:

☒ Land Use Consent ☐ Subdivision Consent

2. The Agent / Consultant

Name of Agent (include the contact person's name if a company, trust or similar):

Landline:

Mobile:

Email:

Postal Address:

3. The Applicant

(Note: The Applicant is responsible to the Council for all costs associated with this application)

Full Name: BRUCE CHARLES JESSEP

Landline: 03 3218608

Mobile: 021 2718608

Email: bruce.jessep@agresearch.co.nz

Postal Address: 133 Greenpark Rd Greenpark

Signature of Applicant (Or person authorised to sign on behalf of Applicant)

Signature: Bruce C Jessep

Date: 19/6/19

Name: Bruce C Jessep

4. The Site

Location of the proposed activity (street address): 116 McDonalds Road Lincoln

Legal description of application site (state legal description (see the Certificate of Title) as at the date of application and, if titles are not yet available, include details of relevant lot numbers and subdivision consent number):

5. The Proposal

Describe what is to be carried out on the site, including a list of the ways it does not comply with the Selwyn District Plan

- * Gaining exemption from existing consent for building on site.
- * To close to boundary. Have been advised to apply for exemption consent. As the position of the containers to the boundary, it does not affect anyone.
- * Advice from Planner, No problem seen to allow

Was there any pre-application advice / discussion prior to this application being filled out?

☒ Y ☐ N

If Yes, what was the Planner's Name?: Richard

6. Attachment

Assessment of any effects on the environment in accordance with Schedule 4 of the Resource Management Act 1991.

I attach:

- ☐ AEE This section **MUST** be completed to a level of detail that corresponds with the scale and significance of the effects that the proposed activity may have on the environment. (Use additional pages as necessary).
- ☒ A recent search of the Certificate of Title From S.D.C.
- ☒ Details of proposal including plans + Photos.
- ☒ Sufficient detail to satisfy the requirements of the NES for Assessing & Managing Contaminants in Soil to Protect Human Health
- ☐ Geotechnical report (subdivision only)

7. Other Applications

Have you applied for, or are you required to apply for, any other resource consents for this project, either from the Selwyn District Council or Environment Canterbury, and if so, what type?

		Has been applied for	Is required to be applied for	Has been obtained
Selwyn District Council	Subdivision Consent	<input type="checkbox"/>	<input type="checkbox"/>	<input type="checkbox"/>
	Other Land Use Consent	<input type="checkbox"/>	<input type="checkbox"/>	<input type="checkbox"/>
Environment Canterbury	Water Permit	<input type="checkbox"/>	<input type="checkbox"/>	<input type="checkbox"/>
	Discharge Permit	<input type="checkbox"/>	<input type="checkbox"/>	<input type="checkbox"/>
	Coastal Permit	<input type="checkbox"/>	<input type="checkbox"/>	<input type="checkbox"/>

OR

- ☒ No additional resource consents are needed for the proposed activity

Have you applied for a Project Information Memorandum (PIM) or a building consent for this project?

☒ Y ☐ N

If so, what is the PIM/BC number?

180748.1

8. Notification

Are you requesting the application to be publicly notified?

☐ Y ☒ N

Are you requesting the application to be limited notified (as not all parties considered affected have provided their written approval)

(Please note it is at the discretion of Council if an application should be limited notified)

☐ Y ☒ N

Have all the persons you consider to be adversely affected given their written approval to the proposal?

(ensure affected persons form is completed & plans signed)

☐ Y ☒ N

9. Privacy Information

All the relevant information on this form is required to be provided under the Resource Management Act 1991 for Selwyn District Council to process your application. Under this Act this information has to be made available to members of the public, including business organisations. The information contained in this application may be made available to other departments of the Council. You have the right to access the personal information held about you by the Council which can be readily retrieved. You can also request that the Council correct any personal information it holds about you.

10. Information

1. All applicants are asked to check the accuracy of the information supplied. Inaccuracies in information supplied can cause difficulties at a later date, such as additional costs, delays and legal proceedings initiated by the Council and/or by other persons.
2. If resource consent is granted the applicant has a legal obligation to comply with any conditions of the consent.
3. The required **Application Fee** must be paid before processing of any application will start.
4. A further invoice will be sent to the applicant when the processing of this application has been completed if the cost of processing it exceeds the fee paid (excluding fixed fee applications). If you are an agent for the owner and do not wish to be legally liable for additional fees then you should ask the **owner** to sign the form.
5. At the completion of the process any refunds due will be issued to the **person who paid the fee** (excluding fixed fee applications).
6. Dependant on the nature of the proposal other consents/licences may also be requested under such legislation as the Health Act 1956 and the Sale of Liquor Act 1989.
7. The application for resource consent under the Resource Management Act 1991 is in addition to any building consent application required under the Building Act 2004.
8. The written approval of persons the Council considers may be adversely affected by the proposal may be required as part of the application, if it is to be processed on a non-notified basis. This will be determined after the application has been lodged and assessed, and if necessary, a site visit carried out.
9. Consultation with neighbours and other affected persons is at the discretion of and responsibility of the applicant.
10. When this application is lodged with the Selwyn District Council, it becomes public information and is available for public inspection. If there is commercially sensitive information in the proposal, please let us know.
11. **If your application is inadequate, it may be returned unprocessed.** If additional information is required, you will be advised and processing of the application will be suspended until the information is received. To avoid delays and cost it is in your best interests to submit a complete application.

Office Check

☐ Information received and complete yes / no Resource consent #: _____ Date: _____

☐ Receipt #: _____

1901 p 940

Cert of Title

940

THE NEW ZEALAND GAZETTE.

[No. 40

Setting a Reserve in the Springs Road Board.

RANFURLY, Governor.
ORDER IN COUNCIL.

At the Government Buildings, at Wellington, this seven-
teenth day of April, 1901.

Present:

THE HONOURABLE W. O. WALKER PRESIDING IN COUNCIL.

WHEREAS the land mentioned in the Schedule hereto
was permanently set apart for a gravel-pit on the
tenth day of January, one thousand nine hundred and one:
And whereas, in the opinion of the Governor, it is expedient
to vest the said land in the Springs Road Board:

Now, therefore, His Excellency the Governor of the
Colony of New Zealand, acting by and with the advice and
consent of the Executive Council of the said colony, and in
exercise of the powers and authorities vested in him by the
fourth section of "The Public Reserves Act, 1881," doth
hereby declare that, from and after the day of the date
hereof, the reserve mentioned in the Schedule hereto shall
become vested in "The Inhabitants of the Springs Road
District," in trust, for the purpose of a gravel-pit.

SCHEDULE.

ALL that parcel of land in the Canterbury Land District,
containing by admeasurement 5 acres, more or less, being
Reserve No. 8587, Block V., Halswell Survey District,
Bounded towards the north-west by McDonald's Road,
1095.5 links; towards the south-east by Rural Section
No. 7806, 1036 links; and towards the south-west by a
road-line, 1095.5 links: be all the aforesaid linkages more
or less; as the same is delineated on the plan deposited in
the District Lands and Survey Office, Christchurch.

ALEX. WILLIS,
Clerk of the Executive Council.

*Revoking Delegation of Powers under "The Public Reserves
Act, 1881," to the Pukekohe Domain Board.*

RANFURLY, Governor.
ORDER IN COUNCIL.

At the Government Buildings, at Wellington, this seven-
teenth day of April, 1901.

Present:

THE HONOURABLE W. O. WALKER PRESIDING IN COUNCIL.

IN pursuance and exercise of the powers and authorities
vested in him by "The Public Reserves Act, 1881,"
His Excellency the Governor of the Colony of New Zealand,
by and with the advice and consent of the Executive Council
thereof, doth hereby revoke a certain Order in Council,
made and issued on the thirteenth day of September, one
thousand eight hundred and ninety-eight, under the said
Act, and delegating all the powers conferred by the said Act
(except the powers conferred by sections five and twelve of
such Act) in respect of the parcel of land known as Sections
Nos. 1, 2, 3, 4, and 41, Village of Pukekohe, Block XL, Opanake
Survey District, Taranaki Land District, to the following

persons, who are known as the Pukekohe Domain Board,
namely:—

HENRY DODGE,
TIMOTHY MALONEY, and
CHARLES DAVIES.

ALEX. WILLIS,
Clerk of the Executive Council.

*Amended Regulation under "The Land for Settlements
Consolidation Act, 1900."*

RANFURLY, Governor.

WHEREAS by Order in Council made on the first day
of February, one thousand eight hundred and ninety-
seven, and gazetted on the fourth idem, certain regulations
were made by the Governor in Council fixing the terms and
conditions for the disposition and occupation of lands
acquired under "The Land for Settlements Act, 1894," and
its amendments: And whereas it is expedient to revoke
clause ten of the said regulations, and to make another in
lieu thereof to permit of preference being given to applica-
tions for land from married men with families:

Now, therefore, His Excellency the Governor of the
Colony of New Zealand, in pursuance and exercise of the
powers and authorities conferred upon him by "The Land
for Settlements Consolidation Act, 1900," doth hereby revoke
the aforesaid clause ten, and in lieu thereof doth hereby
substitute the following clause, and declares that it shall be
known as clause 10A of the said regulations, and shall be
read with them accordingly:—

10A. When more applications than one are made for the
same land, preference shall be given to the applications
from married men with families, and the right to occupy
the land shall, if such applications are accepted by the Land
Board, be decided by ballot in accordance with the regula-
tions under "The Land Act, 1893."

As witness the hand of His Excellency the Governor,
this eighteenth day of April, one thousand nine
hundred and one.

T. Y. DUNCAN,
Minister of Lands.

*Revoking a Warrant appointing Trustees for the Gladstone
Public Cemetery.*

RANFURLY, Governor.

IN pursuance and exercise of the powers and authorities
vested in me by the sixth section of "The Cemeteries
Act, 1882," I, Uchter John Mark, Earl of Ranfurly, the
Governor of the Colony of New Zealand, do hereby revoke
the Warrant appointing trustees for the Gladstone Public
Cemetery, dated the thirtieth day of July, one thousand
eight hundred and eighty-three, and published in the *New
Zealand Gazette* No. 75, of the second day of August, one
thousand eight hundred and eighty-three.

As witness the hand of His Excellency the Governor,
this eighteenth day of April, one thousand
nine hundred and one.

T. Y. DUNCAN,
Minister of Lands.

By Authority: JOHN MACKEY, Government Printer, Wellington.

Reference Number: 180748.1

Project Location: 116 McDonald Road Lincoln

Project Description: Farm Building

**Resource
Consent
Required**

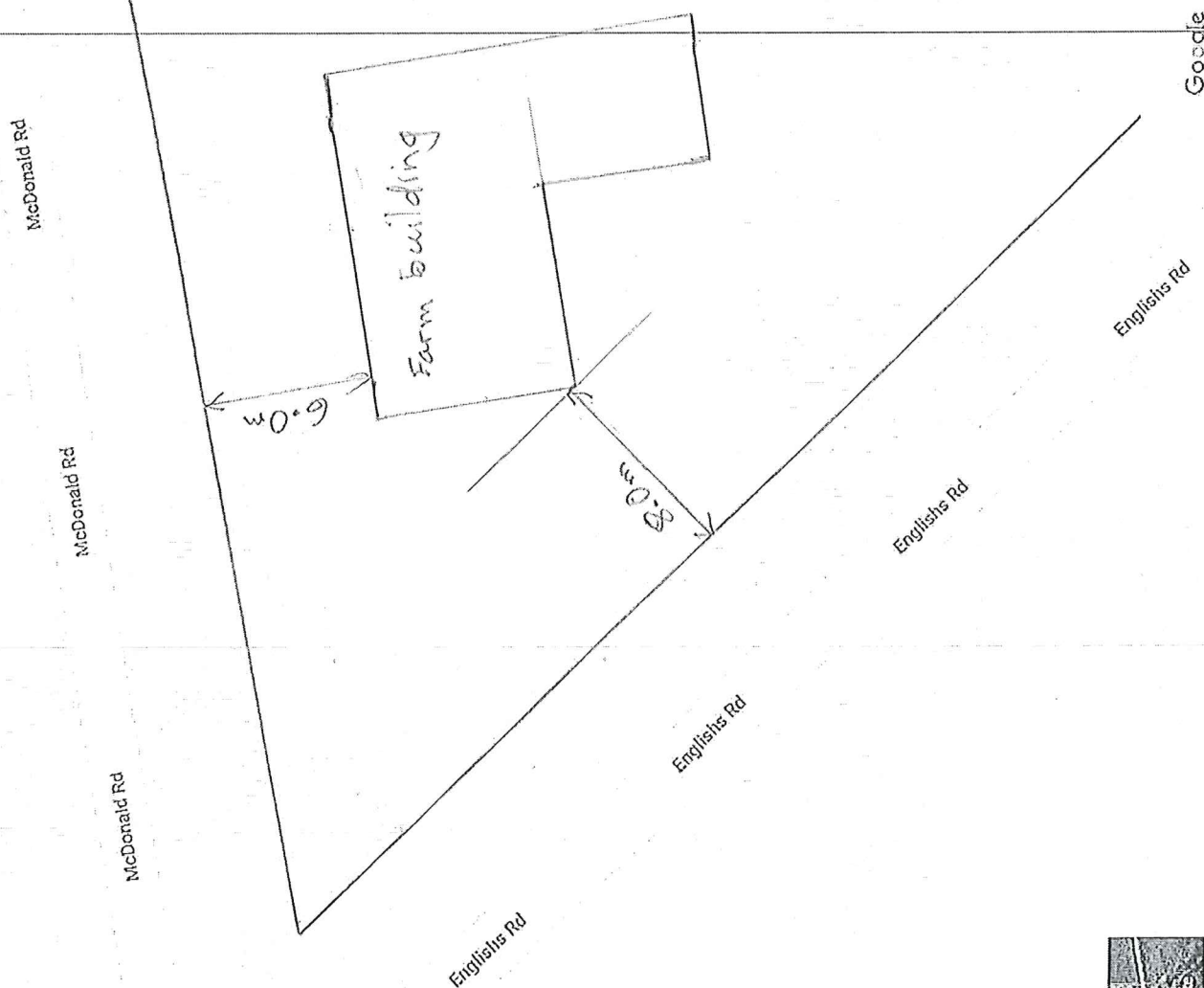

Planning Unit

National Environmental Standard (NES) for Assessing and Managing Contaminants in Soil to Protect Human Health

Resource Management Act 1991

Form PLG1

Send or deliver your form to: Selwyn District Council, PO Box 90, Rolleston 7643

For enquiries phone: (03) 347-2868

For enquiries email: planninginfo@selwyn.govt.nz

Notes

Every applicant must answer the questions contained within Table One. For assistance in answering these questions please refer to the attached information sheet (PLG1A).

Please note that any inaccuracies may result in the applicant being in breach of the Resource Management Act 1991 and / or exposed to liability if the site is subsequently found to be contaminated, including being liable for remedial works.

Table One

Please identify whether the application involves any of the activities below:		
Does your application involve changing the use of the land? (e.g. erecting a dwelling on an area of land which previously had no dwelling erected upon it)	<input checked="" type="checkbox"/> Y	<input type="checkbox"/> N
Does the proposed activity involve disturbance of soil? (more than 25m ³ per 500m ² of land) or removing soil? (more than 5m ³ per 500m ² of land) (e.g. foundations, on-site effluent treatment and disposal systems, wells or bores)	<input type="checkbox"/> Y	<input checked="" type="checkbox"/> N
Does the application involve removing or replacing a fuel storage system or parts of it?	<input type="checkbox"/> Y	<input checked="" type="checkbox"/> N
Does the proposed activity involve sampling soil?	<input type="checkbox"/> Y	<input checked="" type="checkbox"/> N
Are you proposing to subdivide the land as part of this application?	<input type="checkbox"/> Y	<input checked="" type="checkbox"/> N

If all of the answers to the questions in Table One are **NO** then you may stop here. You must, however, sign and date the bottom of page 2 of this form.

If you answered **YES** to any of the questions in Table One, you must complete Table Two.

Table Two

Is the land currently being used, has been used in the past, or is likely to have been used for an activity described on the HAIL?

☐ Y ☒ N

If the answer to the question in Table Two is **NO** then you may stop here. You must, however, sign and date the bottom of page 2 of this form.

If you answered **YES** to the question in Table Two, you are required to undertake an assessment in accordance with the National Environmental Standard for Assessing and Managing Contaminants in Soil to Protect Human Health.

Until such time as a satisfactory NES assessment has been undertaken, no building work will be permitted to commence.

For more information on this process please contact the Duty Planner of (03) 347-2868 or go to the Ministry for the Environment website www.mfe.govt.nz/laws/standards/contaminants-in-soil/.

Please complete Table Three.

Table Three

☐ Assessment under the NES is attached

☐ The assessment work is to be undertaken. Anticipated completion date?

Applicant

Full Name: Bruce Charles Jessep

Landline: 03 3218608

Mobile: 021 2718608

Email: bruce.jessep@agresearch.co.nz

Postal Address: Post Code:

133 Greenpark Rd Greenpark

Signature of Applicant (Or person authorised to sign on behalf of Applicant)

Signature: Bruce C Jessep

Date: 18/06/19

Name: Bruce C Jessep

Privacy Information

All the relevant information on this form is required to be provided under the Resource Management Act 1991 for Selwyn District Council to process your application. Under this Act this information has to be made available to members of the public, including business organisations. The information contained in this application may be made available to other departments of the Council. You have the right to access the personal information held about you by the Council which can be readily retrieved. You can also request that the Council correct any personal information it holds about you.

Information Sheet (PLG1A)

The past use of hazardous substances in industry, agriculture and horticulture has left a legacy of soil contamination in New Zealand. Where contaminated land is developed or its land use is changed, the potential for this soil contamination to effect human health may be intensified.

The National Environmental Standard (NES) is a national regulation which councils must apply to ensure that contaminants in soil are identified, assessed and if need be remediated before land is developed or the land use is changed. This regulation is required to be applied when applications for either building consent or resource consent are made.

The NES will apply to your proposal if you are undertaking one of the following:

1. Changing the use of a piece of land use, disturbing the soil, removing or replacing of a fuel storage system or parts of it, or undertaking a subdivision (refer to the Ministry for the Environment website <http://www.mfe.govt.nz/laws/standards/contaminants-in-soil/> for a fuller explanation of these activities); and
2. The piece of land on which it is proposed to carry out the activity is either currently being used or is more likely than not to have been used as an activity on the HAIL list.

If your proposal is subject to the NES, a preliminary site investigation will be required. This preliminary site investigation will determine whether a detailed site investigation and resource consent under the NES are required.

The current version of this HAIL list is as follows:

Hazardous Activities and Industries List (HAIL)

A. Chemical manufacture, application and bulk storage

1. Agrichemicals including commercial premises used by spray contractors for filling, storing or washing out tanks for agrichemical application
2. Chemical manufacture, formulation or bulk storage
3. Commercial analytical laboratory sites
4. Corrosives including formulation or bulk storage
5. Dry-cleaning plants including dry-cleaning premises or the bulk storage of dry-cleaning solvents
6. Fertiliser manufacture or bulk storage
7. Gasworks including the manufacture of gas from coal or oil feedstocks
8. Livestock dip or spray race operations
9. Paint manufacture or formulation (excluding retail paint stores)
10. Persistent pesticide bulk storage or use including sport turfs, market gardens, orchards, glass houses or spray sheds
11. Pest control including the premises of commercial pest control operators or any authorities that carry out pest control where bulk storage or preparation of pesticide occurs, including preparation of poisoned baits or filling or washing of tanks for pesticide application
12. Pesticide manufacture (including animal poisons, insecticides, fungicides or herbicides) including the commercial manufacturing, blending, mixing or formulating of pesticides
13. Petroleum or petrochemical industries including a petroleum depot, terminal, blending plant or refinery, or facilities for recovery, reprocessing or recycling petroleum-based materials, or bulk storage of petroleum or petrochemicals above or below ground
14. Pharmaceutical manufacture including the commercial manufacture, blending, mixing or formulation of pharmaceuticals, including animal remedies or the manufacturing of illicit drugs with the potential for environmental discharges
15. Printing including commercial printing using metal type, inks, dyes, or solvents (excluding photocopy shops)
16. Skin or wool processing including a tannery or fellmongery, or any other commercial facility for hide curing, drying, scouring or finishing or storing wool or leather products
17. Storage tanks or drums for fuel, chemicals or liquid waste
18. Wood treatment or preservation including the commercial use of anti-sapstain chemicals during milling, or bulk storage of treated timber outside

B. Electrical and electronic works, power generation and transmission

1. Batteries including the commercial assembling, disassembling, manufacturing or recycling of batteries (but excluding retail battery stores)
2. Electrical transformers including the manufacturing, repairing or disposing of electrical transformers or other heavy electrical equipment
3. Electronics including the commercial manufacturing, reconditioning or recycling of computers, televisions and other electronic devices
4. Power stations, substations or switchyards

C. Explosives and ordnance production, storage and use

1. Explosive or ordnance production, maintenance, dismantling, disposal, bulk storage or re-packaging
2. Gun clubs or rifle ranges, including clay targets clubs that use lead munitions outdoors
3. Training areas set aside exclusively or primarily for the detonation of explosive ammunition

D. Metal extraction, refining and reprocessing, storage and use

1. Abrasive blasting including abrasive blast cleaning (excluding cleaning carried out in fully enclosed booths) or the disposal of abrasive blasting material
2. Foundry operations including the commercial production of metal products by injecting or pouring molten metal into moulds
3. Metal treatment or coating including polishing, anodising, galvanising, pickling, electroplating, or heat treatment or finishing using cyanide compounds
4. Metalliferous ore processing including the chemical or physical extraction of metals, including smelting, refining, fusing or refining metals
5. Engineering workshops with metal fabrication

E. Mineral extraction, refining and reprocessing, storage and use

1. Asbestos products manufacture or disposal including sites with buildings containing asbestos products known to be in a deteriorated condition
2. Asphalt or bitumen manufacture or bulk storage (excluding single-use sites used by a mobile asphalt plant)
3. Cement or lime manufacture using a kiln including the storage of wastes from the manufacturing process
4. Commercial concrete manufacture or commercial cement storage
5. Coal or coke yards
6. Hydrocarbon exploration or production including well sites or flare pits
7. Mining industries (excluding gravel extraction) including exposure of faces or release of groundwater containing hazardous contaminants, or the storage of hazardous wastes including waste dumps or dam tailings

F. Vehicle refuelling, service and repair

1. Airports including fuel storage, workshops, washdown areas, or fire practice areas
2. Brake lining manufacturers, repairers or recyclers
3. Engine reconditioning workshops
4. Motor vehicle workshops
5. Port activities including dry docks or marine vessel maintenance facilities
6. Railway yards including goods-handling yards, workshops, refuelling facilities or maintenance areas
7. Service stations including retail or commercial refuelling facilities
8. Transport depots or yards including areas used for refuelling or the bulk storage of hazardous substances

G. Cemeteries and waste recycling, treatment and disposal

1. Cemeteries
2. Drum or tank reconditioning or recycling
3. Landfill sites
4. Scrap yards including automotive dismantling, wrecking or scrap metal yards
5. Waste disposal to land (excluding where biosolids have been used as soil conditioners)
6. Waste recycling or waste or wastewater treatment

H. Any land that has been subject to the migration of hazardous substances from adjacent land in sufficient quantity that it could be a risk to human health or the environment

I. Any other land that has been subject to the intentional or accidental release of a hazardous substance in sufficient quantity that it could be a risk to human health or the environment

Photo Positions

116

McDonald Rd

McDonald Rd

McDonald Rd

McDonald Rd

McDonald Rd

Englis Rd

Englis Rd

Englis Rd

Englis Rd

Google

249

247

Imagery ©2019 CNES / Airbus, Map data ©2019 MapData Sciences Pty Ltd, PSMA

New Zealand

Terms

Send feedback

20

● Green Arrow from Neighbour towards back container
Englishs Rd.



Red Arrow from Neighbour towards
Container McDonalds Rd



Pink Arrow From Englishs Rd
Back of Container towards Neighbour



● Yellow Arrow From Container towards neighbour McDonalds Rd





Blue Arrow Native Shrub Fence line