

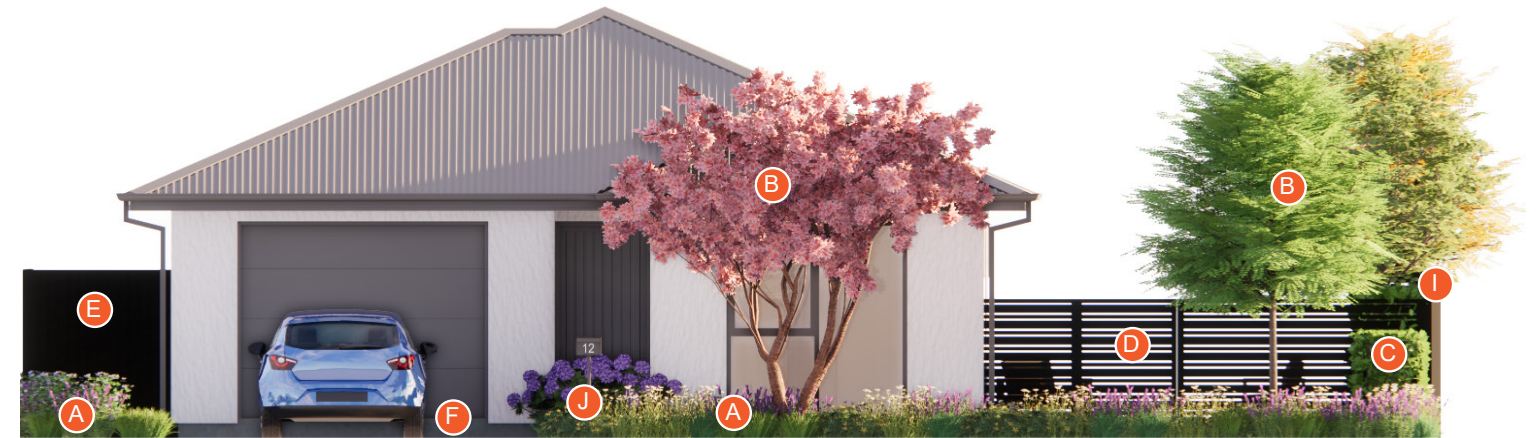

A. TYPICAL PLAN VIEW (1:100 @A3)

LEGEND

- | | | |
|---|--|------------------------------|
| A Low Landscape Planting (~0.5-1m) | E Screening Fence and Gate (1.8m) | I 1.8m Boundary Fence |
| B Specimen Tree | F Driveway | J Letterbox |
| C Hedge (~1.2 - 1.8m) | G Pedestrian Entrance | |
| D Semi-permeable Fence and Gate (1.5m) | H Patio/ Outdoor Living | |



B. TYPICAL ELEVATION

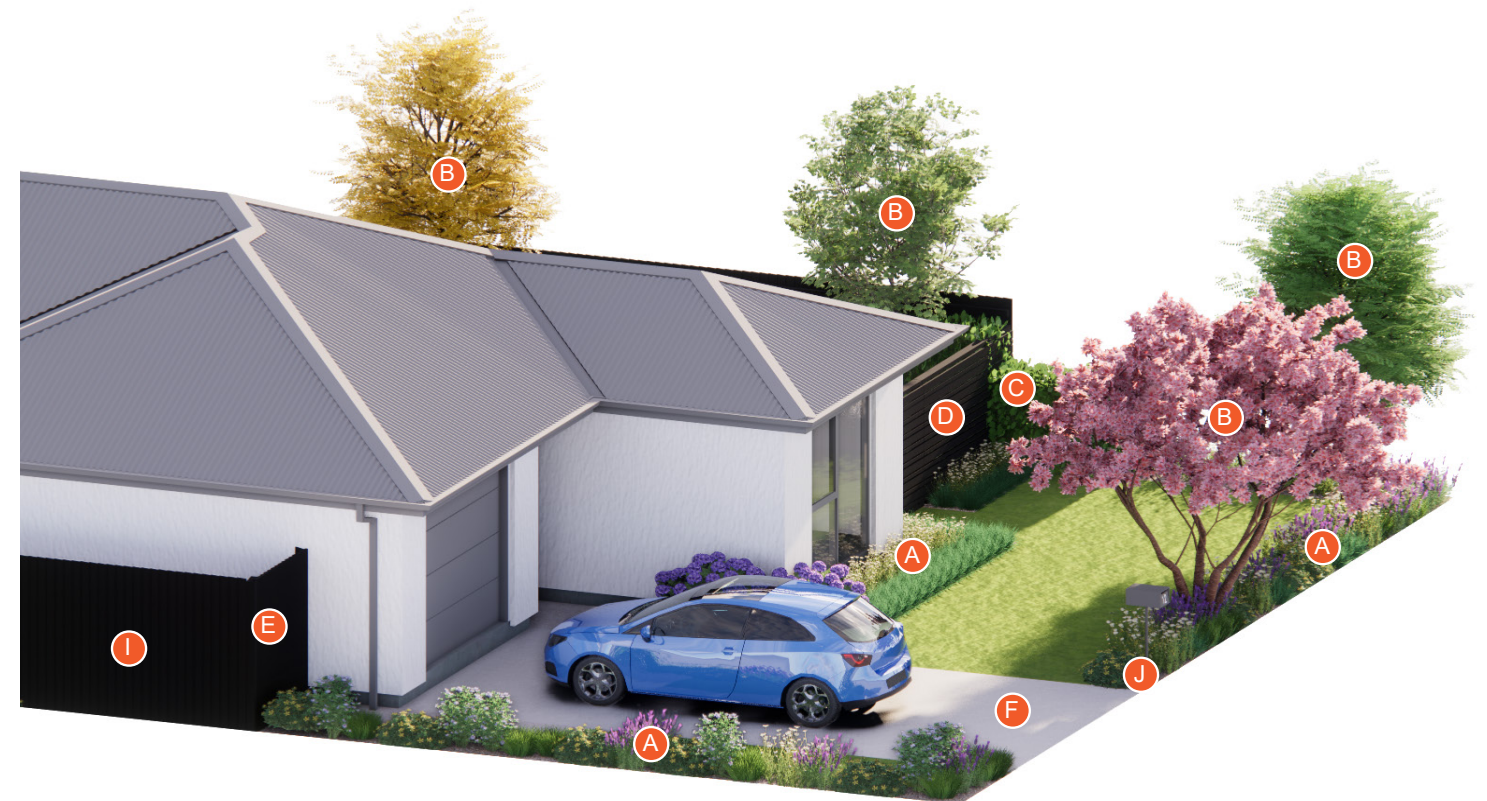

C. TYPICAL PERSPECTIVE